

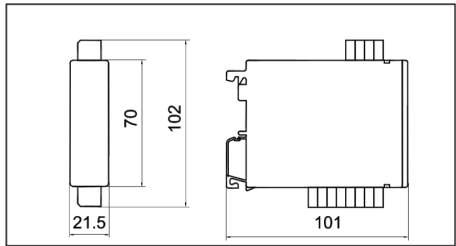

# KET-BAX-100

- Applications
- Accounting



## Atex barrier with galvanic isolation

- For installations in areas at risk of explosive atmospheres
- 1 digital input
- DIN rail mounting
- Galvanically isolated

The **KET-BAX-100** is an **Atex Barrier** designed to transmit On-Off signals from a proximity contact or switch located in a hazardous area to the safe area.

It is equipped with a **digital input** with voltage-free switch or 2-wire proximity sensor and **two relay outputs** (5 A - 250 VAC).

Maximum flexibility of power supply, direct from the mains or low voltage, both DC and AC.

Together with the KET-CGP / CGT gas meters, it is essential in the monitoring of a **gas system** for safety purposes.

| Technical Features     |  |
|------------------------|--|
| General specifications | <b>Protection Range:</b> IP20<br><b>Operative Temperature:</b> -20 ÷ +60 °C<br><b>Storage Temperature:</b> -25 ÷ +70 °C<br><b>Relative Humidity:</b> MAX 95% not condensing  |
| Case                   | <b>Dimensions:</b> 21.5 x 70 x 101 mm (W x H x D)<br><b>Mounting:</b> DIN-rail<br><b>Required DIN modules:</b> 1 DIN module<br><b>Electric Board Type:</b> Industrial or switchboard<br><b>Material:</b> ABS   |
| Power supply           | <b>Supply Voltage:</b> 110 ÷ 230 VAC ±10% (48 ÷ 62 Hz); 12 VDC ±10%; 24 ÷ 48 VDC ±10%<br><b>Consumption:</b> = 4.5 VA or 1.6 W<br><b>Connectors types:</b> Screw terminal  |
| Digital inputs         | <b>Channels:</b> 1<br><b>Digital Inputs:</b> Voltage free switch or 2 wires proximity sensor   |
| Relay outputs          | <b>Channels:</b> 2 switch outputs<br><b>Voltage Output:</b> 250 V @ 5 A; max 100 VA<br><b>Maximum Rated Current:</b> 100 mA<br><b>Isolation:</b> Galvanic isolation 2500 VAC 50 Hz   |
| Certifications         | <b>Referends Standard:</b> EN/IEC 61326, EN/IEC 61000-6-2, EN/IEC 61010-1<br><b>Approvals:</b> ATEX certificate: LCIE 02 ATEX 6104X - INERIS 14 ATEX 3015X; ATEX classification: CE 0081 Ex II (1) G/D; IECEx certificate: IECEx LCI 09.0013X; SIL classification: SIL 2 according to IEC 61508<br><b>Security:</b> EN/IEC 60079-0, EN/IEC 60079-11 [Ex ia] I or [Ex ia] IIC or [Ex ia] IIB [Ex iaD] I or [Ex iaD] IIC or [Ex iaD] IIB, [Ex nA] EN 60079-0, EN 60079-15<br><b>Metrology:</b> |